



# TRIMLINE FIRES

Wood stoves & Pellet stoves  
Edition 2023-2024





# A warm welcome

Thank you for showing interest in Trimline Fires wood stoves. Wood stoves are a sustainable and efficient way to heat your home offering both charm and warmth. Whether you are looking for a traditional wood stove or a modern pellet stove, we have a wide selection to choose from. We hope we can spark some inspiration in you.

## **Innovation and atmosphere**

Those who know our fireplaces know that they burn “like a dream”. But this is no coincidence... Innovating and perfecting our techniques is extremely important for creating the ultimate atmosphere and the perfect burning fireplace. And this is especially true for wood-burning fireplaces. It is the only way to create an ambiance that embraces the experience of special moments.

## **Quality guaranteed**

We specialise in decorative fireplaces. We design and build everything in-house, from start to finish. And we have been doing so with passion and dedication every day since 1974. From the first tests in our laboratory to the final construction in our production department. We do everything we can to create an unparalleled and extremely comfortable atmosphere in your home.

## **Environmentally conscious**

Our wood stoves comply with the European ECO Design guidelines and other various strict standards, including the German BImSchV Stufe 2. This standard is distinguished by its requirement to meet extremely low emission values for particulate matter and carbon monoxide.

## **European network**

Our Trimline Fires fireplaces can be found offering warmth and comfort to homes and residents all over Europe. From the rugged fjords of Norway to the icy peaks of the French Alps, as well as in our own beloved Netherlands as course.





# Trimline Fires creations

<b>A warm welcome</b>	<b>3</b>
<b>Trimline Fires creations, contents</b>	<b>5</b>
<b>Personalise your fireplace</b>	<b>6</b>
<b>Free-standing wood stoves</b>	<b>8</b>
<b>Dutch design</b>	<b>10</b>
<b>Woody Grid, design with a story.</b>	<b>11</b>
<b>Trimline Woody Grid</b>	<b>12</b>
<b>Trimline Woody Grid</b>	<b>14</b>
<b>Trimline Woody Air 6</b>	<b>16</b>
<b>Trimline Woody Air 8</b>	<b>19</b>
<b>Optimal combustion</b>	<b>20</b>
<b>The right way to light a fire</b>	<b>21</b>
<b>Trimline Woody Loft</b>	<b>22</b>
<b>Trimline Woody Loft Pellet</b>	<b>24</b>
<b>Find your style, choose your base.</b>	<b>26</b>
<b>The technology behind the flame</b>	<b>28</b>
<b>Technical drawings</b>	<b>30</b>
<b>Specifications</b>	<b>31</b>
<b>IHS Group</b>	<b>32</b>
<b>Welcome to our showrooms</b>	<b>34</b>



## HIGH QUALITY PRODUCTS

Our options help you  
make your fireplace the  
ultimate in luxury

---



### Find your perfect wood stove.

Trimline Fires has a unique range of wood stoves. We have specialised in ambient heating products for more than 50 years. We develop gas fires and woods stoves from the first sketches to production, we do everything ourselves.

Your fireplace, your style. Create your ultimate feeling of being home by combining your favourite options.

### We only use quality materials

Our combustion chambers are made of 3 mm thick high-quality steel. This is a very robust material that guarantees a long lifespan. The Woody Loft side panels and steel bases are even made of 8 mm thick steel. Not only does this offer a very beautiful design, it also provides ideal energy storage so you can enjoy the heat for a long time.

### Easy installation

Our wood stoves are easy to install. The flue gas exhaust can be connected both on the top side and at the rear of the stove. The connection can be converted to either position easily. Suitable high quality flue gas exhaust material is also available via Trimline Fires.

Use of a combustion air supply is also optional. This takes combustion air directly from outside your home to prevent the air management inside your home being affected. As a result, you never have a shortage of fresh combustion air, which is especially important in airtight homes.

### Fire safety

The stove can be placed close to a combustible wall. This means the stove does not intrude into the room. At only 10 cm from the wall, this is a safe distance. You can neatly store your firewood under the stove in a niche or base. You can also place a floor plate under the stove if you wish. We always have a suitable floor plate available.

### Easy operation

The operation of the stove is simple, a nice door handle can easily be operated with a so-called "cold hand" for opening and closing the stove. An ignition mode is also built into the door handle for an extra boost. Using the "Swiss method", a rapid ignition of the fuel will take place. The stove will then heat up quickly and achieve optimum combustion.

Control over the combustion is possible using a single air slider, which is nicely concealed at the bottom of the door. You can operate this with the supplied "cold hand".



# Free-standing wood stoves

---



Our Woody wood stove range is the ultimate choice for anyone looking for an elegant and efficient way to heat their home. These stoves are made from high quality steel and are designed to last for years to come.





With a capacity of 6-8 kW, Woody wood stoves are suitable for rooms up to 120 m<sup>3</sup> (depending on the room set-up). The glass door provides a beautiful view of the fire and comfortable heating of the room.

A Woody wood stove is also easy to operate thanks to the air distributor. And with no less than 80% efficiency, you are assured of very efficient heating of your home.



## DESIGN WITH A SMILE

A fireplace should always look great, even when the fire is out.

---



7-4-'20  
Q

450x675  
2:3

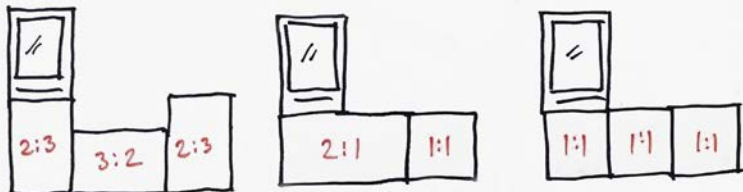
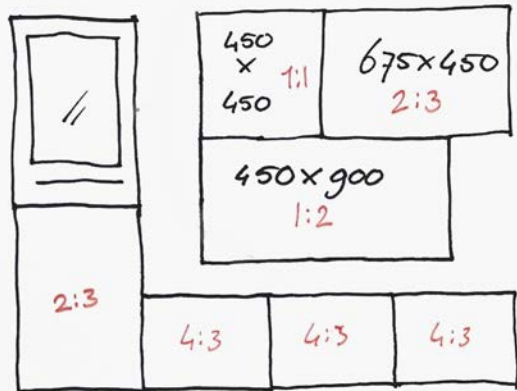

### Feminine Dutch design

Trimline Fires' free-standing fireplace designs are the result of the creative talents of Elke van Raamsdonk. Her fire for design was ignited at the Eindhoven Design Academy. And with subtle adjustments, Elke products are given a feminine touch. Softness, refinement and playfulness characterise her designs.

### Modular wood stove

Her latest design is the Trimline Woody Grid. This design is based on colourful thinking, being a little different, and symmetry. This makes the Woody Grid perfect for your interior.

A custom piece of furniture in which the fireplace is integrated. A unique look that you put together yourself with doors in trendy colours.

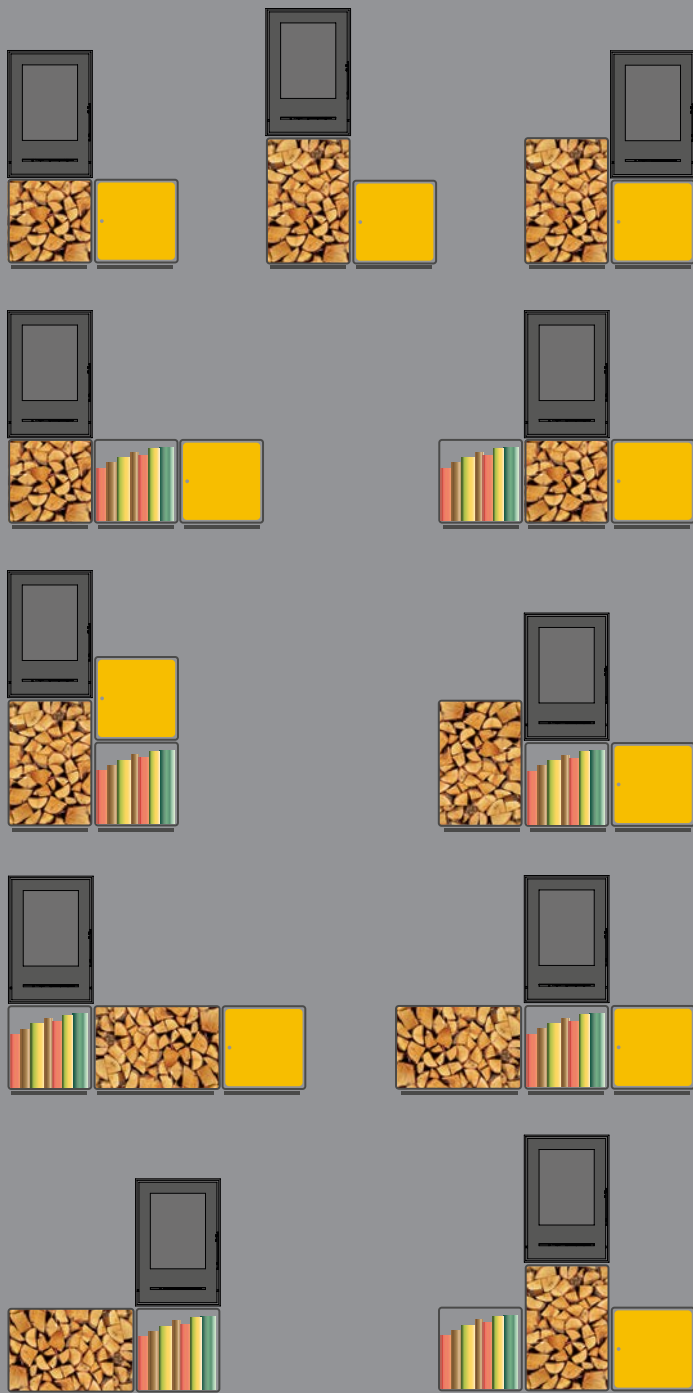

## MODULAR WOOD STOVE

Our Woody Grid,  
plenty of variety  
for your interior.

### Combine endlessly

All combinations are possible with the Trimline Woody Grid. Choose between a rectangular or square block. Or keep it simple, add colour, or build a whole piece of furniture around it. The possibilities are endless.







## Trimline Woody Grid

Due to the many configurations available, the Trimline Woody Grid is everyone's friend. This means the Woody Grid also fits perfectly into your interior. A unique look you can put together yourself. Enjoy the warmth and appearance, and relax with this modular stove.

The wood stove has been tested according to the BImSchV Stufe 2 standard. This German standard is one of the strictest standards in Europe and distinguishes itself from other standards by requiring very low emission values of particulate matter and carbon monoxide for wood-burning appliances.

The excellent performance of the Trimline Woody Grid ensures it easily meets all the requirements that are to become mandatory throughout Europe in the coming years. This means the purchase of a Woody Grid also means anticipating what is to come.









## Trimline Woody Grid

### Choose your variation

The Trimline Woody Grid is available in two variants. The Trimline Woody Grid S, which has the fireplace set on a square block. Or the Trimline Woody Grid R, which has the fireplace set higher up on a rectangular block.

In addition, you can add as many blocks as you want to the basic set-up. Because the elements are separate, you can design your own fireplace furniture completely according to your wishes. If you want to vary the chosen set-up after a while, or you want to make some changes to your interior, the Grid will simply change with you.

### Add some colour to your interior

Complete your fireplace furniture with our coloured doors. As an option, you can add a door and shelf combination to one or more of the square blocks. The door and interior both have the same colour.

These sets are available in the following colours:

Dusty White

Ginger Yellow

Ice Blue

Terra Berry



## Trimline Woody Air 6

The Trimline Woody Air 6 wood stove is a sleek model from the Woody wood stove series. The Woody Air 6 is equipped with a convection mantle around the appliance. This creates a pleasant warmth and allows the stove to be placed closer to combustible materials.

The Trimline Woody Air 6 includes an option to connect the exhaust pipe both at the top and at the back. With an efficiency of 80%, this stove amply meets the requirements of the new European "Eco Design" quality mark.

The wood stove has been tested according to the BImSchV Stufe 2 standard. This German standard is one of the strictest standards in Europe and distinguishes itself from other standards by requiring very low emission values of particulate matter and carbon monoxide for wood-burning appliances.











## Trimline Woody Air 8

The big brother of the Trimline Woody Air 6 is the Air 8. A similar appearance, but just a bit bigger to provide more heat capacity.

The Trimline Woody Air 8, like the Air 6, has the option to connect the pipe at both the top and rear. With an efficiency of 80%, this stove amply meets the requirements of the new European "Eco Design" quality mark.

The wood stove has been tested according to the BImSchV Stufe 2 standard. This German standard is one of the strictest standards in Europe and distinguishes itself from other standards by requiring very low emission values of particulate matter and carbon monoxide for wood-burning appliances.



## THE SWISS METHOD

# Optimal combustion without nuisance

---

While developing our wood stoves, we take low emissions very seriously. But the way in which the stove is fired up is also extremely important. Wood that ignites quickly and burns optimally creates the lowest emissions and achieves the highest efficiency.

The correct way to ignite the stove is with the so-called Swiss method. The fire is quickly ignited from the top to quickly bring the entire fireplace and flue system up to temperature. In addition, it is important to use the correct wood. Generally speaking, this is deciduous wood such as very dry oak or birch with a moisture content of less than 20%.

### Important heating tips:

- Make sure the appliance power output is correct: a stove that is too large is often suffocated and causes higher emissions.
- Never use waste or processed wood for burning.
- Do not light the fire when it is windless or foggy outside.
- Set the fire on an ash bed for optimum combustion.
- Make sure the fireplace and exhaust are cleaned regularly.
- Have the fireplace installed by a recognised installation technician to guarantee safe installation.
- A sign of a good fire is minimal smoke from the chimney



Start by laying two large logs side by side, bark side down. On this place 2 smaller logs next to each other, but rotated 90 degrees.



## A well-lit fire using the right method



Now place small kindling wood on this in the same direction as the bottom layer. Place some kindling wood, turned a quarter turn, on top of that.



Put some firelighter shavings or firelighter cubes at the very top. Make sure the oxygen supply is turned all the way on. Light the firelighters.



Enjoy your fire.  
Allow everything to almost burn out before adding new wood.



## Trimline Woody Loft

The design of the Trimline Woody Loft is based on tranquillity, rhythm and symmetry. The Woody Loft also fits into any interior: a modern look with pure materials. The ribbed side gives the stove a sturdy, solid look, while the oak base adds a natural touch to the design. The connection to the flue can be made from both the top and the rear.

The wood stove has been tested according to the BImSchV Stufe 2 standard. This German standard is one of the strictest standards in Europe and distinguishes itself from other standards by requiring very low emission values of particulate matter and carbon monoxide for wood-burning appliances.

### **Various bases**

A product should not only be beautiful, but also practical to use. The wooden base is also available as a separate table. The base of the stove is available in different designs. In addition to wood, there are also 3 steel variations available, see page 26.









## Trimline Woody Loft Pellet

The graceful design of the Trimline Woody Loft in the wood stove version is very popular. This pellet version is distinguished by a compact design with thick steel and natural oak base that provides a beautiful visual balance.

The base of the stove is available in different designs. In addition to wood, there are also 3 steel variations available, see page 26.

This pellet stove is a pleasant way to warm a room. No more lugging wood around, and once the pellet bunker is filled with wood pellets, it provides hours of enjoyable warmth. The supplied remote control, which can also serve as a room thermostat, makes operation easy. The high-quality technology and insulated combustion chamber ensure optimal combustion. This results in low emissions and very high efficiency. The Trimline Woody Loft pellet stove uses natural convection airflow and is very quiet.

The installation is flexible. The flue gas exhaust can be connected at the top or the rear. And an exterior air connection will ensure this pellet stove gets fresh combustion air directly from outside. This pellet stove can also be used safely in airtight homes.

In short, a special piece of compact technology with a great design.

## TRIMLINE WOODY LOFT

Find your style,  
choose your base.

---



### Wood

This wooden base belongs to the original design of the Woody Loft. A modern combination of pure materials.



### Bars small

The grooves are the same as those of the combustion chamber. This gives a balanced look to the fireplace as a whole.



### Steel

Those looking for a more traditional fireplace with a modern touch will be happy with this sleek frame.



### Bars wide

The rhythm of the combustion chamber grooves partly continues in the base. An airy whole on which the fireplace almost seems to float.





### Woodspacer

It is also possible to raise the fireplace by 7.5 cm using a woodspacer. This can be used on any steel base.



## OPTIMAL COMBUSTION

### The technology behind the fire

---

#### Low emissions & high efficiency

We have been working on ideal wood combustion in our laboratory for a long time, and we have achieved fantastic results. Low particulate matter emissions and high efficiency are achieved with a well-insulated refractory combustion chamber. Setting up the fire on a layer of ash on a closed bottom, and using efficiency baffles in combination with optimal air regulation, results in very low emissions.

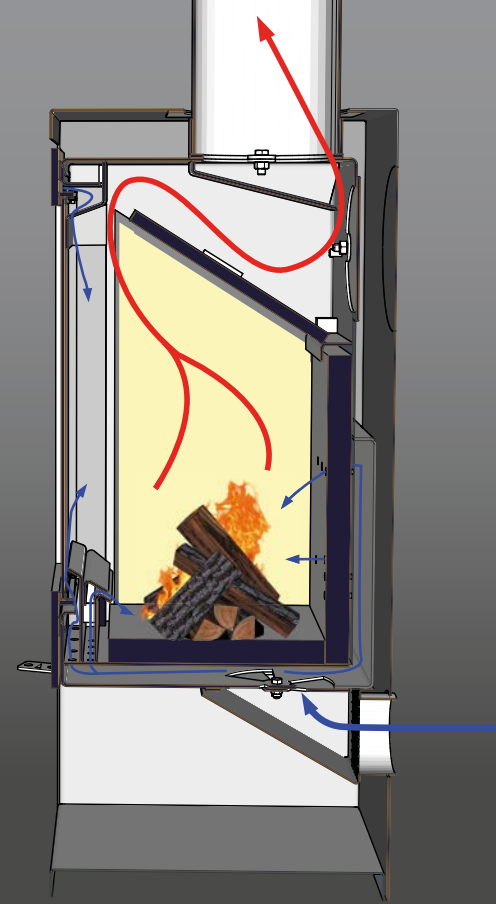

#### 3-way airflow

In addition to a primary air supply in the combustion chamber that quickly ignites the wood, a secondary air supply via the glass panel flushes preheated air into the chamber. The result is a cleaner glass panel and optimum combustion. The rear of the combustion chamber houses a so-called tertiary air supply. This creates an after burn effect of the fuel and flue gases. These applied techniques have enabled us to create a stove that meets the highest ECO Design and German BImSchV Stufe 2 emission requirements.





### Stainless steel flue systems

A good wood or pellet stove only operates optimal when it is installed correctly with a flue gas exhaust system of perfect quality.

We recommend the Holetherm flue gas system, which is made of stainless steel.

- Well insulated, heats up quickly, and ensures stable combustion in a wood stove or pellet stove, resulting in low emissions.
- The correct fuel and good combustion results in minimal deposits in the exhaust system.
- Safety; gas tight flue and fire resistant chimney. Holetherm Evolution offers warranty up to 30 years.
- Resistant to the flue gases of both wood and pellet stoves.
- CE approved according to the highest European standard.
- EW DECO, the perfect connection material of smooth pipe with no visible locking bands, in the colour of the wood or pellet stove.
- Fast installation, easy to connect system elements.
- Unique implementation through flammable floors and roofs with the Holetherm BENG.
- The BENG complies with the latest building decree regarding airtight and energy-efficient buildings.





# Free-standing wood stoves

## DIMENSIONS

Trimline Woody Grid S/R

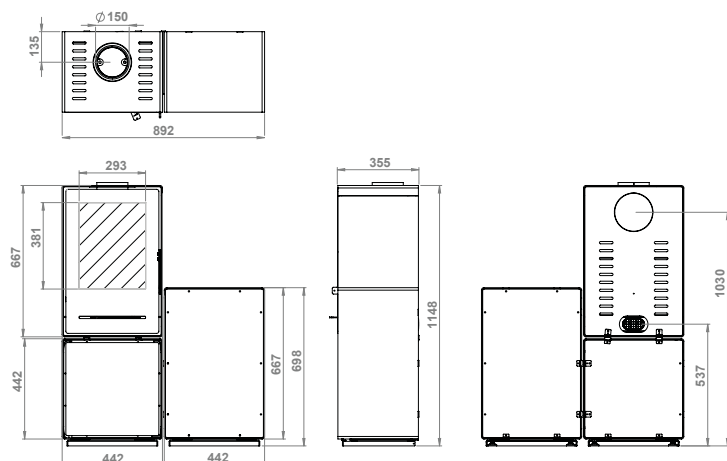

Trimline Woody Air 6

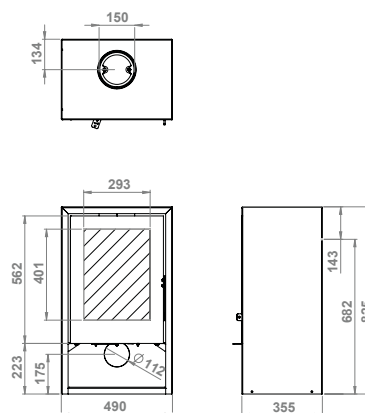

Trimline Woody Air 8

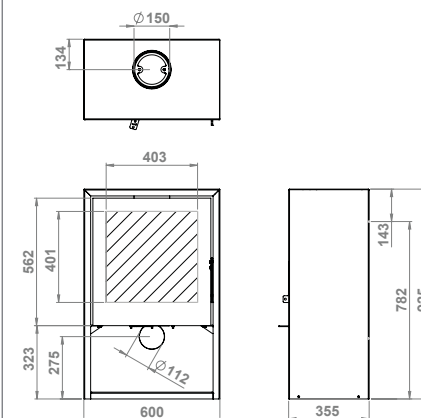

Trimline Woody Loft Pellet - Wood

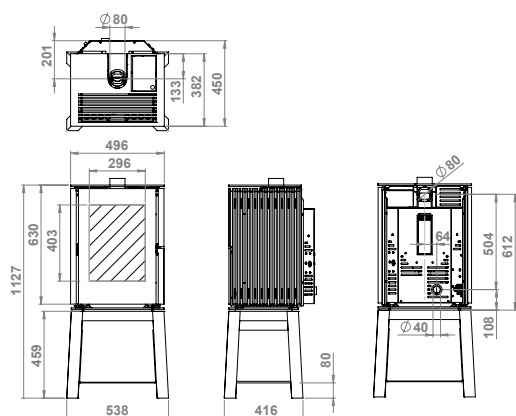

Trimline Woody Loft Pellet - Steel

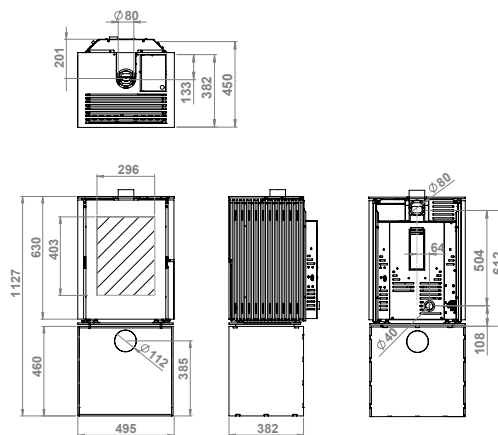

Trimline Woody Loft Pellet - Bars S/W

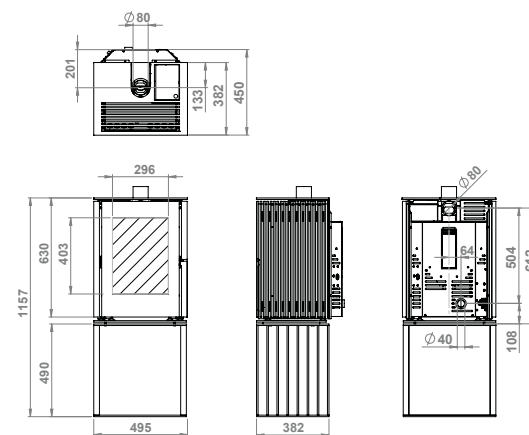

# Technical information

## SPECIFICATIONS

Appliance name wood stove	Woody Grid S/R	Woody Air 6	Woody Air 8	Woody Loft
Heat output max. (kW)	6.4	6.4	7.0	6.4
Heat output min. (kW)	2.5	2.5	3.0	2.5
Wood consumption (kg/h)	1.8	1.8	2.0	1.8
Wood log length (cm)	20	20	24	20
Flue gas (mm)	Ø 150	Ø 150	Ø 150	Ø 150
Air supply (mm)	Ø 80	Ø 80	Ø 80	Ø 80
Combustion chamber weight (kg)	103			148
Total weight (kg)	132 (S), 141 (R)	95	113	162 Wood, 186 Steel, 203 Bars S, 176 Bars W
Efficiency (%)	80	80	80	80
Energy label	A	A	A	A
Distance to combustible wall (mm)	100	100	100	100
Certification	ECO DESIGN 2015/1185, EN 13240/A2:2004, DIN+, BlmSchV Stufe 2, Flamme Verte			
Optional	Exterior air connection, Holetherm EW DECO flue gas exhaust material, DHK floor plates and accessories			

Appliance name pellet stove	Woody Loft Pellet
Heat output max. (kW)	6.1
Heat output min. (kW)	3.0
Pellet consumption (kg/h)	1.3
Pellet size (mm)	Ø 7, length 30
Pellet reservoir capacity in kg	10.3
Flue gas (mm)	Ø 80
Air supply (mm)	Ø 40
Weight (kg)	102
Total weight (kg)	116 Wood, 140 Steel, 157 Bars S, 130 Bars W
Energy label	A+
Efficiency (%)	89.4
Distance to combustible wall (mm)	50
Max power consumption (W)	320
Mains voltage (VAC)	230-50 Hz
Certification	EN 14785:2006, Flamme Verte
Optional	Holetherm EW flue gas exhaust material, DHK pellet storage

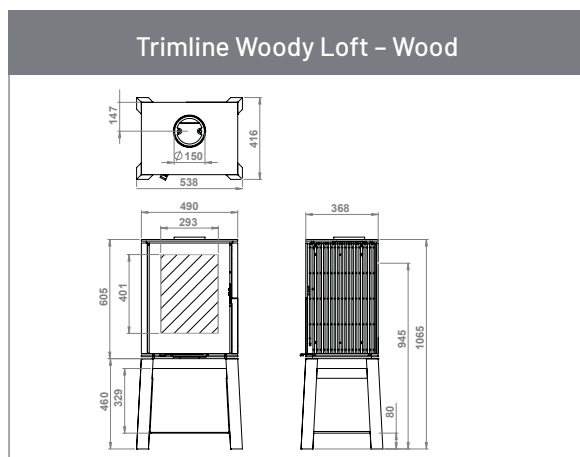



## INNOVATIVE HEATING SOLUTIONS GROUP

All your fire needs, provided by  
our unique solutions

---



Innovative Heating Solutions Group (the IHS Group) is a collection of Dutch companies consisting of LEWO BV., Home Fire BV. and thermoCet International BV. The IHS Group is a leading producer and distributor of innovative, sustainable ambient heating products.

### Everything you need in one place

With unique stoves, fireplace solutions, flue gas systems, accessories and other parts, the IHS Group meets the complete needs and specific wishes of every customer.



### thermoCet International BV.

thermoCet has been active in the development and production of gas and wood-fired fireplaces since 1974. Products are developed by our own R&D department and ultimately CE approved. The utmost care is given to quality, durability, installation and ease of operation. Production and assembly take place in our own factory. The fireplaces have been sold under the name Trimline Fires since 2019, and the range of gas fireplaces has been further expanded with built-in and free-standing fireplaces, wood and pellet stoves, and electric fireplaces.

### LEWO BV.

Under the name Holetherm, metal ware factory LEWO produces high-quality flue gas exhaust systems from stainless steel in Woudenberg. The development of new products also takes place in our own ISO-certified factory. Since 2022, De Hoeken B.V. (DHK) has been integrated within LEWO. As a result, LEWO now also offers a complete range of fireplace parts and accessories to complete the installation of your fireplace.

### Home Fire BV.

With more than 30 years of experience, Home Fire is a supplier of high-quality ambient fires. Home Fire specialises in the design, creation, and project-based delivery of unique fireplace solutions. The result is beautiful projects for luxurious residential and holiday homes, design gardens and hospitality. Due to the unique combination of companies, Home Fire can deliver a project from A to Z. This is where the strength of the IHS Group and its products come together.



## A VERY WARM WELCOME

Find your own style and  
make your dreams come true

---



Even though this is the final page of our brochure, Trimline Fires has even more to offer.



Fire has a magical, spiritual quality, and Trimline Fires fireplaces have that quality too. Come and see how our flames burn in real life. Scan this QR code to be taken directly to our website [www.trimlinefires.com](http://www.trimlinefires.com).

We hope to inspire you even more through our social media channels, so please don't hesitate to follow us for more stunning home decor examples, videos and information.

We are very curious to see what your dream fireplace looks like. Tag us on social media and show us your spark.

You are always welcome to view our fireplaces at one of our qualified dealers, or you can pay a visit to our Creation Centre. Light up your fire, feel the heat, and create the ultimate atmosphere with our heart-warming creations.



This brochure has been compiled with the utmost care. Trimline Fires reserves the right however to change the designs and specifications without notice.





*Heart-warming creations*



Trimline Fires

Gas fireplaces | Electric fireplaces | Wood stoves | Pellet stoves

thermoCet International B.V.

Laagerfseweg 27, 3931 PC Woudenberg, Netherlands

[info@www.trimlinefires.com](mailto:info@www.trimlinefires.com)

[www.trimlinefires.com](http://www.trimlinefires.com)