

## Fit wide frame profiles for:

- Trimline 63H F
- Trimline 73 F
- Trimline 73H T
- Trimline 100 F/T
- Trimline 120 F/T
- Trimline 140 F/T
- Trimline 170 F

### ⚠ WARNING

The wide frame profiles cannot be retrofitted.

Exercise care when removing the wide frame profiles and accessories from their packaging to avoid scratches.

The set contains the following items: ①

- Wide frame profiles. ① ② ③
- Self-drilling screws and spacers. ④
- Brackets ⑤ for clamping the wide frame profiles. ③

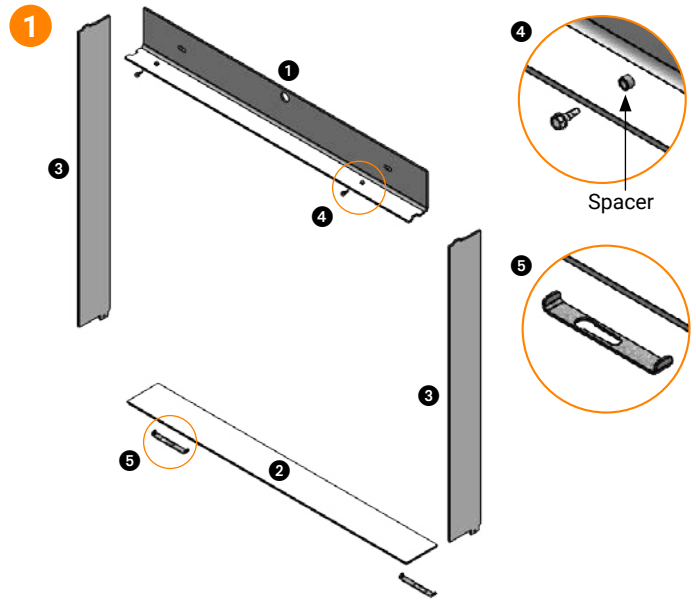

## STEP 1

Place the top frame profile ① on the narrow lip on the front panel on the stove ②. Centre the profile accurately relative to the centre of the stove (drawing), align the top profile with the front trim edge. In the case of stoves with predrilled fixing holes, secure the upper profile using the screws and spacers provided. Do not over tighten the screws, the profile needs to be able to slide.

In the case of stoves with no predrilled fixing holes, the top frame profile ① must be fastened to the existing front panel using the self-drilling screws. After pre-drilling with the self-drilling screws, remove the front panel from the appliance and drill a 5 mm hole in the convection box ③. Refit the front panel and fasten the top frame profile using the screws and spacers. Do not over tighten the screws, the profile needs to be able to slide.

### ⚠ CAUTION

In the case of the Trimline 63H F, 73 F and 73H T models, the 2 vertical glazing beads ④ must be removed before fitting the side frame profiles ③. These glazing beads are no longer required.

Alignment



5 mm hole



## STEP 2

Loosen the left-hand and right-hand hexagon socket head screws that secure the bottom glazing bead. Fit the left-hand and right-hand frame profiles ③; they hook behind the top wide frame profile. ① Fit the brackets ⑤ on the left and right, slide them against the wide frame profiles and retighten the hexagon socket head screws. ⑤



## STEP 3

### ⚠ CAUTION

Work carefully to avoid damaging the wide side profiles.

The wide frame profile ② can now be positioned between the side profiles ③.

### ⚠ CAUTION

The housing may not make contact with the wide frame profiles due to expansion of the stove when hot.

While fitting the remaining refractory material, ensure a clearance gap of a few millimetres to the wide frame profile. The finishing strip on the frame surrounds the glass. ⑥

